

### Selection Chart for Shock Absorber Accessories



Locknut



Stop Collar



Mounting Block/  
Clamp Mount\*\*



Rectangular  
Flange

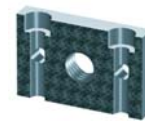

Universal  
Mount



Side Load  
Adaptor\*

#### Shock Absorber Type

**KM**

**AH**

**MB**

**RF**

**UM**

**BV**

#### Thread Size M6 x 0.5

MC 9 M	KM 6	AH 6	MB 6 SC <sup>2</sup>	RF 6	-	-
--------	------	------	----------------------	------	---	---

#### Thread Size M8 x 1

MA 30 M	KM 8	AH 8	MB 8 SC <sup>2</sup>	RF 8	-	BV 8
MC 10 M	KM 8	AH 8	MB 8 SC <sup>2</sup>	RF 8	-	BV 8-A
MC 30 M	KM 8	AH 8	MB 8 SC <sup>2</sup>	RF 8	-	BV 8

#### Thread Size M10 x 1

MA 50 M	KM 10	AH 10	MB 10 SC <sup>2</sup>	RF 10	UM 10	BV 10
MC 25 M	KM 10	AH 10	MB 10 SC <sup>2</sup>	RF 10	UM 10	BV 10
SC <sup>2</sup> 25 M	KM 10	AH 10	MB 10 SC <sup>2</sup>	RF 10	UM 10	on request
FA 1008	KM 10	AH 10	MB 10 SC <sup>2</sup>	RF 10	UM 10	-

#### Thread Size M12 x 1

MA 35 M	KM 12	AH 12	MB 12	RF 12	UM 12	BV 12
MC 75 M	KM 12	AH 12	MB 12	RF 12	UM 12	BV 12
SC <sup>2</sup> 75 M	KM 12	AH 12	MB 12 SC <sup>2</sup>	RF 12	UM 12	BV 12 SC

#### Thread Size M14 x 1.5

MA 150 M	KM 14	AH 14	MB 14	RF 14	UM 14	BV 14
MC 150 M	KM 14	AH 14	MB 14	RF 14	UM 14	BV 14
SC 190 M 0-4	KM 14	AH 14	MB 14	RF 14	UM 14	BV 14 SC
SC <sup>2</sup> 190 M 5-7	KM 14	AH 14	MB 14 SC <sup>2</sup>	RF 14	UM 14	BV 14

#### Thread Size M20 x 1.5

MA 225 M	KM 20	AH 20	MB 20	RF 20	UM 20	BV 20 SC
MC 225 M	KM 20	AH 20	MB 20	RF 20	UM 20	BV 20
SC 300 M 0-4	KM 20	AH 20	MB 20	RF 20	UM 20	BV 20 SC
SC <sup>2</sup> 300 M 5-7	KM 20	AH 20	MB 20 SC <sup>2</sup>	RF 20	UM 20	BV 20 SC

#### Thread Size M25 x 1.5

MA 600 M	KM 25	AH 25	MB 25	RF 25	UM 25	BV 25 SC
MA 900 M	KM 25	AH 25	MB 25	RF 25	UM 25	-
MC 600 M	KM 25	AH 25	MB 25	RF 25	UM 25	BV 25
SC 650 M 0-4	KM 25	AH 25	MB 25	RF 25	UM 25	BV 25 SC
SC 925 M	KM 25	AH 25	MB 25	RF 25	UM 25	-
SC <sup>2</sup> 650 M 5-9	KM 25	AH 25	MB 25 SC <sup>2</sup>	RF 25	UM 25	BV 25 SC

\* Only mountable on units without button.

Remove the button from the shock absorber, if there's one fitted. See page 34.

\*\* Use a locknut for protection if a clamp mount MB... SC<sup>2</sup> is installed.

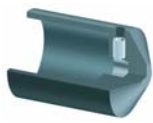

Steel Shroud\*

**PB**



Air Bleed Collar

**SP**



Switch Stop Collar

**AS**



Steel Button

**PS**

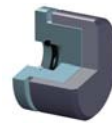

Steel/Urethane Button

**BP**



Nylon Button

**PP**

**Page**

### Thread Size M6 x 0.5

-	-	-	-	-	-	30
---	---	---	---	---	---	----

### Thread Size M8 x 1

PB 8	-	-	-	-	-	30
PB 8-A	-	-	-	-	-	30
PB 8	-	-	-	-	-	30

### Thread Size M10 x 1

PB 10	-	AS 10	PS 10	-	-	30
PB 10	-	AS 10	PS 10	-	-	30
PB 10 SC	-	-	-	-	-	30
-	-	-	-	-	-	30

### Thread Size M12 x 1

PB 12	-	AS 12	PS 12	-	-	31
PB 12	-	AS 12	PS 12	-	-	31
PB 12 SC	SP 12	AS 12	PS 12 SC	-	-	31

### Thread Size M14 x 1.5

PB 14	SP 14	AS 14	PS 14	-	included	31
PB 14	SP 14	AS 14	PS 14	-	PP 150	31
PB SC	-	AS 14	included	BP 14	-	31
PB 14	SP 14	AS 14	PS 14	-	-	31

### Thread Size M20 x 1.5

PB 20 SC	-	AS 20	included	BP 20	-	32
PB 20	SP 20	AS 20	PS 20	-	PP 225	32
PB 20 SC	-	AS 20	included	BP 20	-	32
PB 20 SC	-	AS 20	included	-	-	32

### Thread Size M25 x 1.5

PB 25 SC	-	AS 25	included	BP 25	-	32
-	-	AS 25	included	BP 25	-	32
PB 25	SP 25	AS 25	PS 25	-	PP 600	32
PB 25 SC	-	AS 25	included	BP 25	-	32
-	-	AS 25	included	BP 25	-	32
PB 25	-	AS 25	included	-	-	32

\* Only mountable on units without button.  
Remove the button from the shock absorber, if there's one fitted. See page 34.

**Dimensions see pages 30 to 32.**

### M6x0.5

**KM 6**

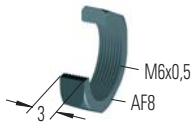

Locknut

**AH 6**

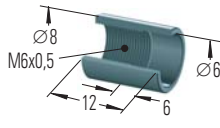

Stop Collar

**MB 6 SC<sup>2</sup>**

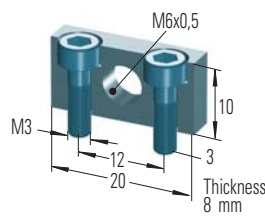

Mounting Block

**RF 6**

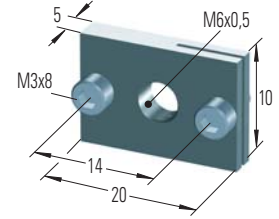

Rectangular Flange

### M8x1

**KM 8**

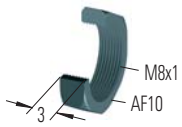

Locknut

**AH 8**

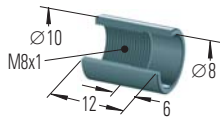

Stop Collar

**MB 8 SC<sup>2</sup>**

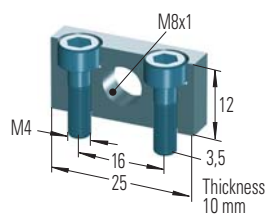

Mounting Block

**RF 8**

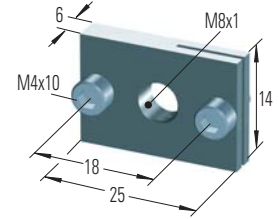

Rectangular Flange

**BV 8**

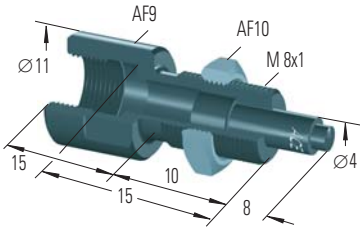

Side Load Adaptor

**BV 8-A**

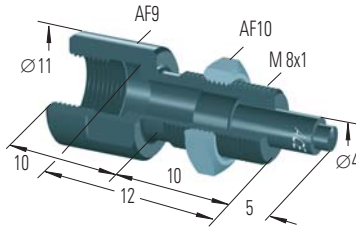

Side Load Adaptor

**PB 8**

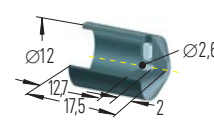

Steel Shroud

**PB 8-A**

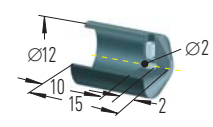

Steel Shroud

### M10x1

**KM 10**

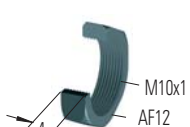

Locknut

**AH 10**

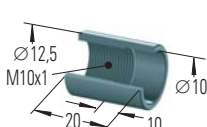

Stop Collar

**MB 10 SC<sup>2</sup>**

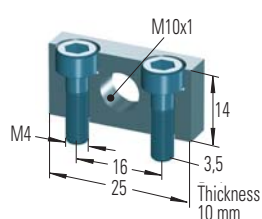

Mounting Block

**RF 10**

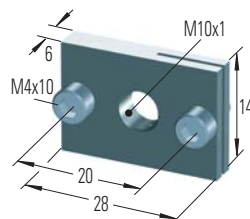

Rectangular Flange

**UM 10**

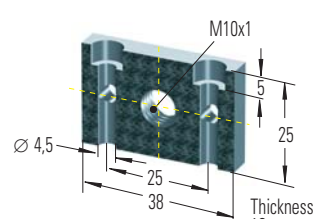

Universal Mount

**BV 10**

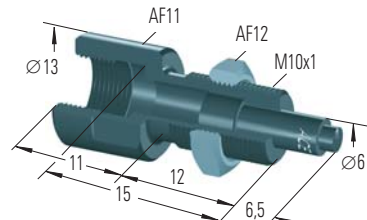

Side Load Adaptor

**PB 10**

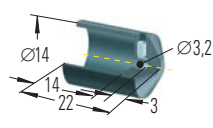

Steel Shroud

**PB 10 SC**

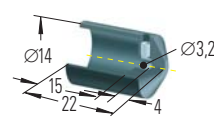

Steel Shroud

**PS 10**

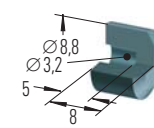

Steel Button

**AS 10**

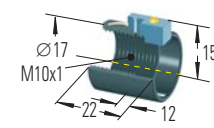

Switch Stop Collar  
inc. Proximity Switch

### M 12x1

**KM 12**

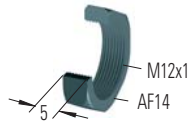

Locknut

**AH 12**

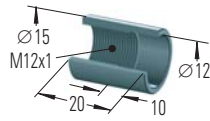

Stop Collar

**MB 12**

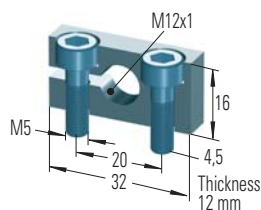

Clamp Mount

**MB 12 SC<sup>2</sup>**

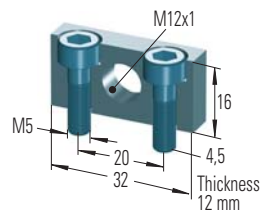

Mounting Block

**RF 12**

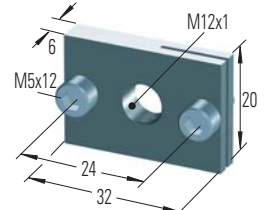

Rectangular Flange

**UM 12**

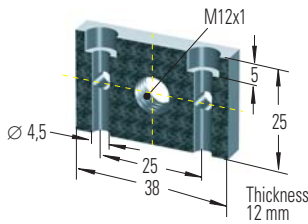

Universal Mount

**BV 12**

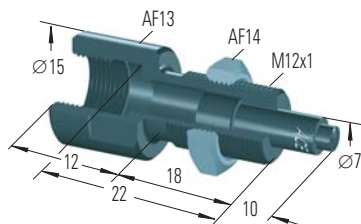

Side Load Adaptor

**BV 12 SC**

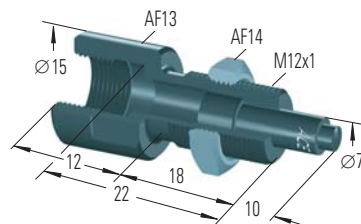

Side Load Adaptor

**SP 12**

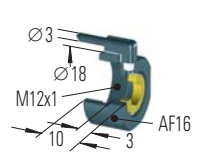

Air Bleed Collar

**PB 12**

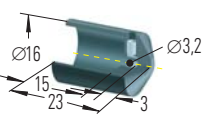

Steel Shroud

**PB 12 SC**

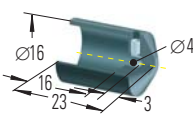

Steel Shroud

**PS 12**

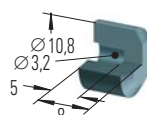

Steel Button

**PS 12 SC**

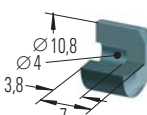

Steel Button

**AS 12**

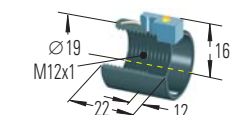

Switch Stop Collar  
inc. Proximity Switch

### M 14x1.5

**KM 14**

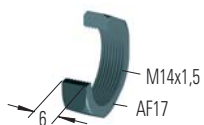

Locknut

**AH 14**

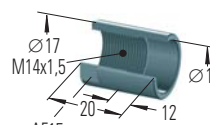

Stop Collar

**MB 14**

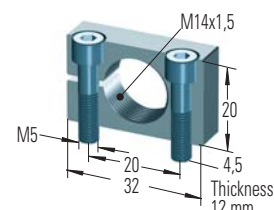

Clamp Mount

**MB 14 SC<sup>2</sup>**

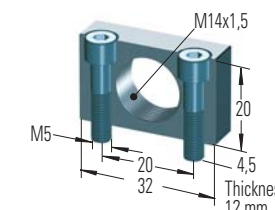

Mounting Block

**RF 14**

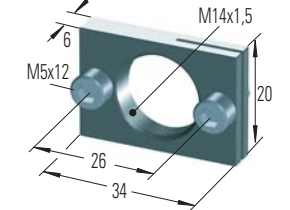

Rectangular Flange

**UM 14**

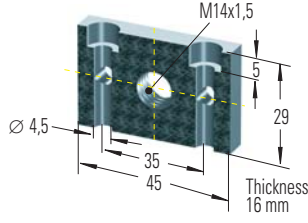

Universal Mount

**BV 14**

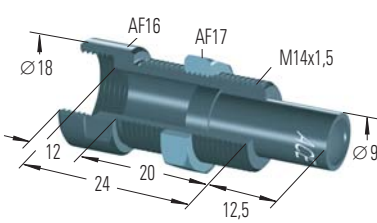

Side Load Adaptor

**BV 14 SC**

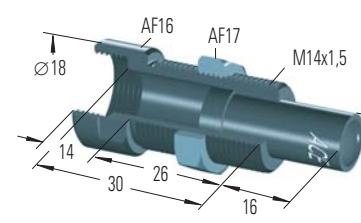

Side Load Adaptor

**PB 14**

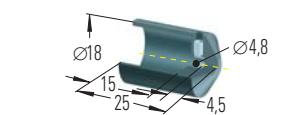

Steel Shroud

**PB 14 SC**

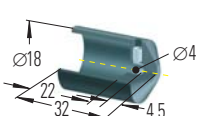

Steel Shroud

**SP 14**

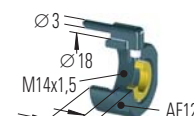

Air Bleed Collar

**PS 14**

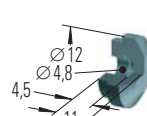

Steel Button

**AS 14**

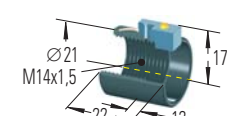

Switch Stop Collar  
inc. Proximity Switch

**PP 150**

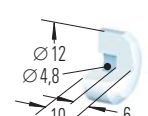

Nylon Button

**BP 14**

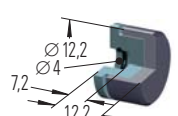

Steel/Urethane  
Button

### M20x1.5

**KM 20**

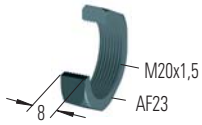

Locknut

**AH 20**

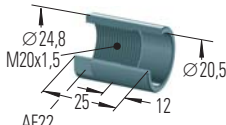

Stop Collar

**MB 20**

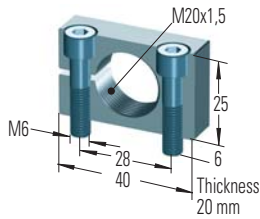

Clamp Mount

**MB 20 SC<sup>2</sup>**

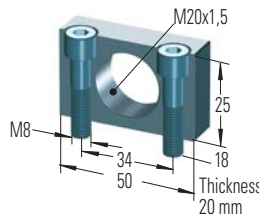

Mounting Block

**RF 20**

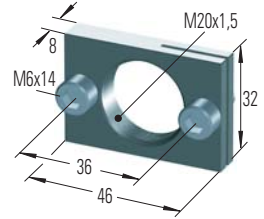

Rectangular Flange

**UM 20**

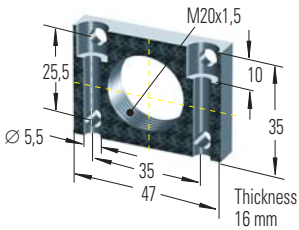

Universal Mount

**BV 20**

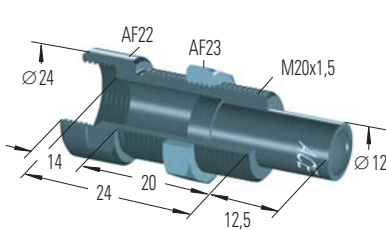

Side Load Adaptor

**BV 20 SC**

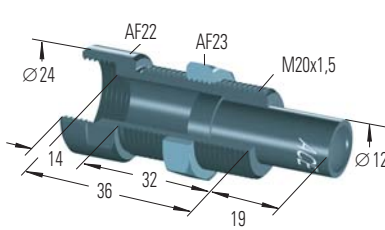

Side Load Adaptor

**PB 20**

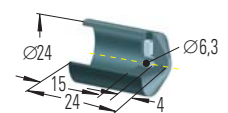

Steel Shroud

**PB 20 SC**

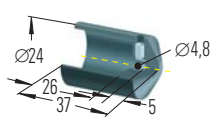

Steel Shroud

**SP 20**

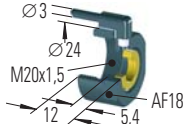

Air Bleed Collar

**PS 20**

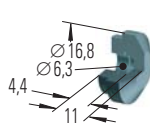

Steel Button

**AS 20**

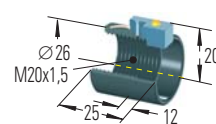

Switch Stop Collar  
inc. Proximity Switch

**PP 225**

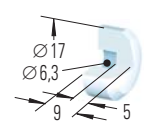

Nylon Button

**BP 20**

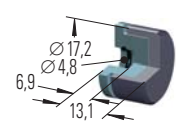

Steel/Urethane  
Button

### M25x1.5

**KM 25**

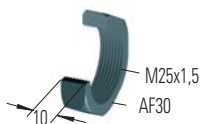

Locknut

**AH 25**



Stop Collar

**MB 25**

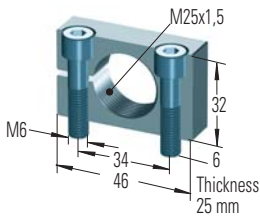

Clamp Mount

**MB 25 SC<sup>2</sup>**

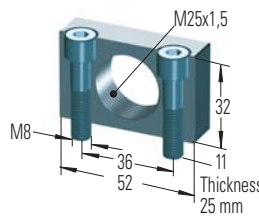

Mounting Block

**RF 25**

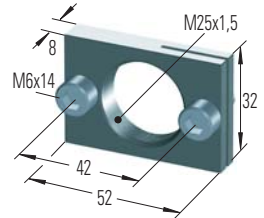

Rectangular Flange

**UM 25**

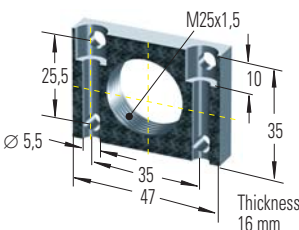

Universal Mount

**BV 25**

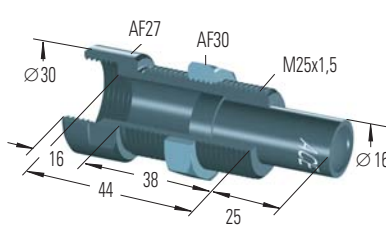

Side Load Adaptor

**BV 25 SC**

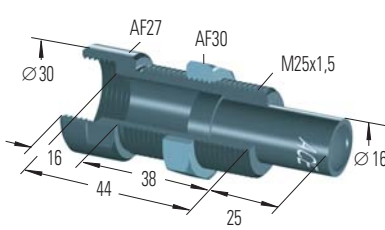

Side Load Adaptor

**PB 25**

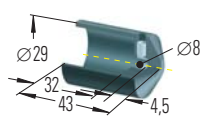

Steel Shroud

**PB 25 SC**

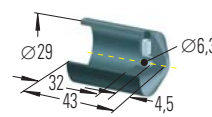

Steel Shroud

**SP 25**

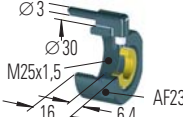

Air Bleed Collar

**PS 25**

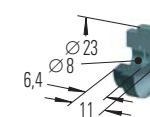

Steel Button

**AS 25**

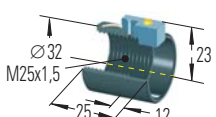

Switch Stop Collar  
inc. Proximity Switch

**PP 600**

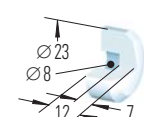

Nylon Button

**BP 25**

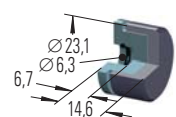

Steel/Urethane  
Button

Accessories, mounting, installation... see pages 33 to 35.