

Base plates



Material:
Grey cast iron GJL 250

Surface finish:
Mounting surfaces, ground

Sample order:
nlm 01127-005060

Note:
The base plates are positioned using close-tolerance bolts 07533-12055, which are placed in the location holes. The clearance holes for DIN 912 attachment bolts are used for further attachment.

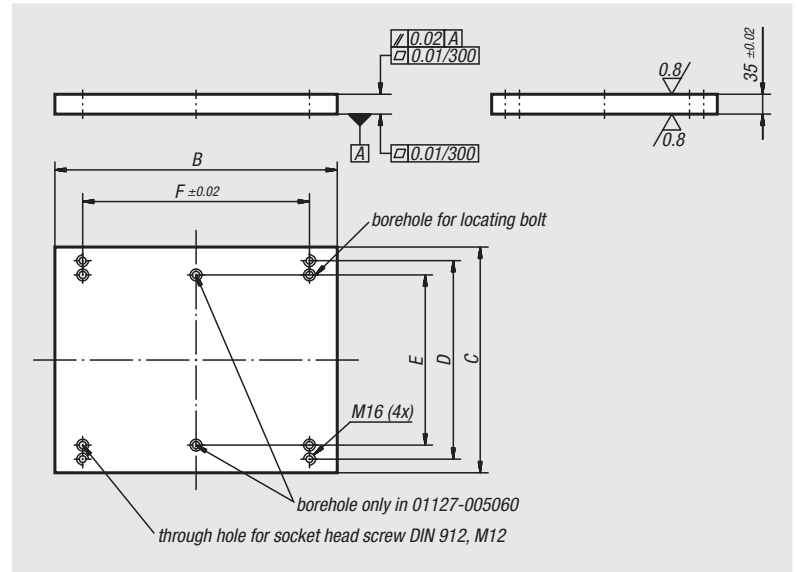

Order No.	B	C	D	E	F	Suitable locating bolt	Approx. weight kg
01127-003040	398	298	250	200	300	07533-12055	31
01127-004050	498	398	350	300	400	07533-12055	51
01127-005060	598	498	450	400	500	07533-12055	77

Rectangular precision steel plates



Material:
Steel 1.1730

Surface finish:
Natural finish, ground

Sample order:
nlm 01130-04X500
(Please also indicate dimension L)

Note:
The precision steel plates are particularly suitable base plates in the mechanical engineering, tool-making and device construction industries. The dimension L is machined by saw blade and is always supplied with an excess.

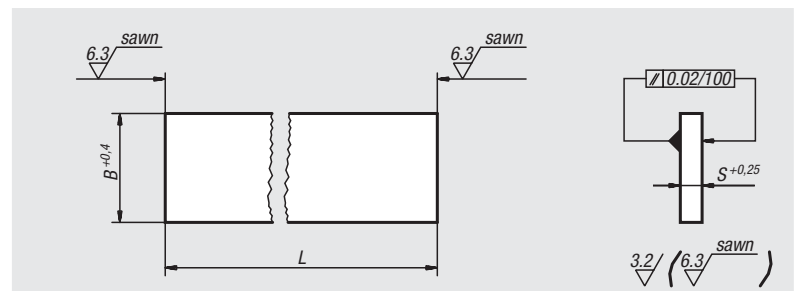

Order No.	L = length	B	S	Approx. weight kg/100
01130-01X	250/500/750/1000	40	8	0,251
01130-02X	250/500/750/1000	50	10	0,393
01130-03X	250/500/750/1000	63	12	0,593
01130-04X	250/500/750/1000	80	16	1,005
01130-05X	250/500/750/1000	100	16	1,256
01130-06X	250/500/750/1000	100	20	1,570
01130-07X	250/500/750/1000	125	25	2,453
01130-08X	250/500/750/1000	150	25	2,944
01130-09X	250/500/750/1000	160	32	4,019
01130-10X	250/500/750/1000	200	32	5,024
01130-11X	250/500/750/1000	300	40	9,420