

# Safety tension levers

with internal thread



### Material:

Steel parts quality class 5.8;  
black plastic ball knob

### Surface finish:

Plastic-coated with fine texture, black

### Sample order:

nIm 06382-1108

### Method of operation:

To operate safety tension levers, press the handle down until the teeth are fully engaged. The object concerned can now be clamped or released. Spring pressure releases the locking mechanism immediately, thereby restoring the safety function (handle can be turned effortlessly).

### On request:

Special versions.

Dimensions „H1“ and „A“ available in other lengths at extra charge.

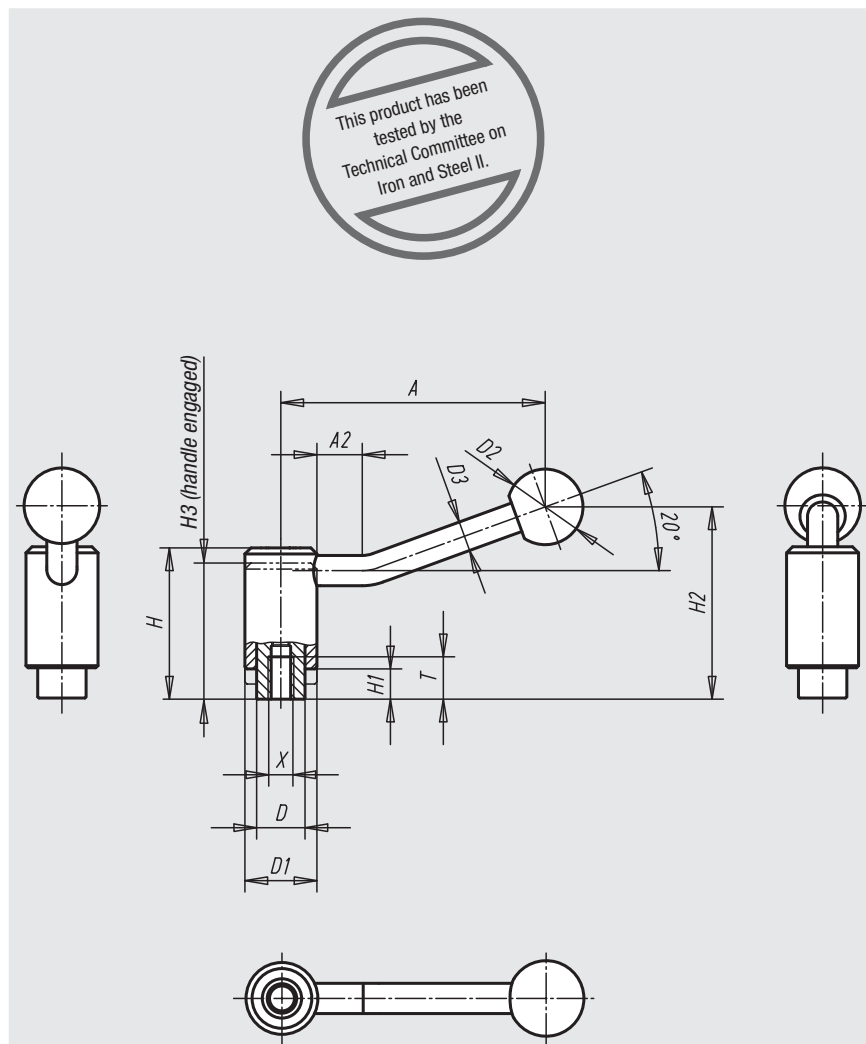

engage  
by pressing  
(safety function)

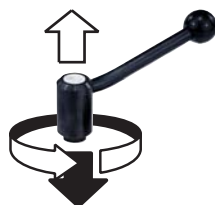

Order No.	Size	Internal thread X	T	D	D1	D2	D3	H	H1	H2	H3	A	A2	No. of teeth	Approx. weight kg
06382-1108	1	M8	14	16	24	25	10	49,5	9,5	63,5	44,5	88	15	22	0,160
06382-1110	1	M10	14	16	24	25	10	49,5	9,5	63,5	44,5	88	15	22	0,160
06382-1210	2	M10	17	19	28	32	12	56,5	10,5	74	51	106	15	24	0,250
06382-1212	2	M12	17	19	28	32	12	56,5	10,5	74	51	106	15	24	0,250
06382-1312	3	M12	23	23	33	32	13	64,5	12,5	87,5	57,5	128,5	15	26	0,370
06382-1316	3	M16	23	23	33	32	13	64,5	12,5	87,5	57,5	128,5	15	26	0,370