

07160

# Socket head screws

DIN 912/DIN EN ISO 4762



**Material:**  
Steel or stainless steel (A 2)

**Surface finish:**  
Steel class 8.8, black;  
stainless steel A 2-70, natural finish

**Sample order:**  
nlm 07160-08X40  
(Please also indicate dimension L)

**Note:**  
The screw length 18 as well as the versions 07160-105X40 and 07160-106X55 are not available in stainless steel.

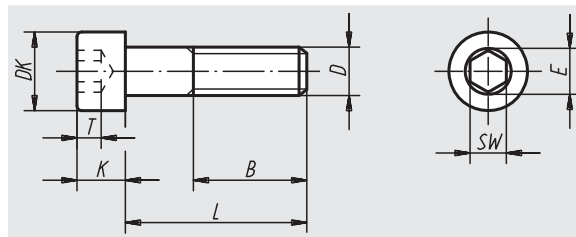
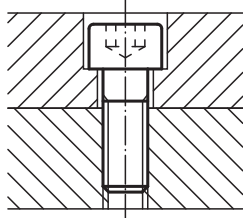

Order No. steel	Order No. stainless steel	D	L	B	DK	K	E	SW	T
07160-04X	07160-104X	M4	10/12/16/18/20/25	20	7	4	3,44	3	2
07160-05X	07160-105X	M5	10/12/16/18/20/25/30/40	22	8,5	5	4,58	4	2,5
07160-06X	07160-106X	M6	10/12/16/18/20/25/30/35/40/45/50/55/60	24	10	6	5,72	5	3
07160-08X	07160-108X	M8	16/18/20/25/30/35/40/45/50/60/70/80	28	13	8	6,86	6	4
07160-10X	07160-110X	M10	16/18/20/25/30/35/40/45/50/60/70/80/90/100	32	16	10	9,15	8	5
07160-12X	07160-112X	M12	20/25/30/40/50/60/70/80/90/100/110/120/35/45	36	18	12	11,43	10	6
07160-14X	-	M14	50/80/120	40	21	14	13,9	12	7
07160-16X	-	M16	30/35/40/45/50/60/70/80/90/100/110/120	44	24	16	16	14	8
07160-20X	-	M20	40/45/50/60/70/80/90/100/110/120	52	30	20	19,44	17	10

07160

# Socket head screws

DIN 912/DIN EN ISO 4762



**Material:**  
Steel

**Surface finish:**  
Steel class 12.9, black

**Sample order:**  
nlm 07160-206X40 (Please also indicate dimension L)

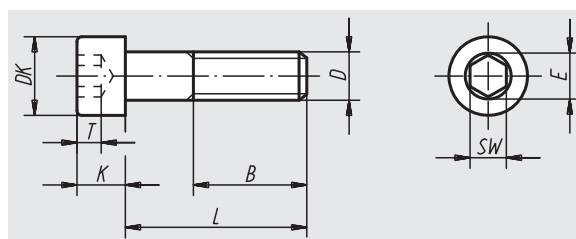
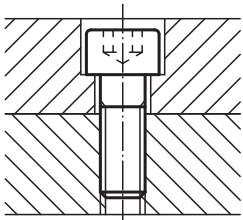

Order No.	D	L	B	DK	K	E	SW	T
07160-206X	M6	18/20/25/30/35/40/45/50/55/60/65/70/80/90/100	24	10	6	5,72	5	3
07160-210X	M10	30/35/40/45/50/55/60/65/70/75/80/90/100/110/120/130/140	32	16	10	9,15	8	5
07160-216X	M16	35/40/45/50/55/60/65/70/75/80/90/100/110/120/130/140/150/160/170/180/200	44	24	16	16	14	8

01000  
02000  
03000  
04000  
05000  
06000  
07000  
08000  
09000  
20000  
21000  
22000  
23000