

Hexagon Socket Set Screws with pointed tip

DIN 914

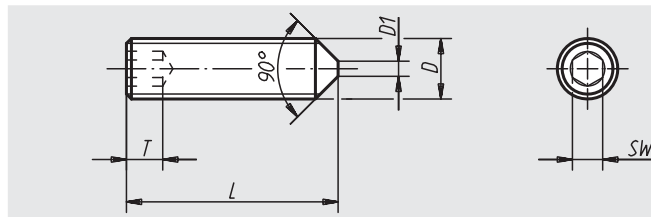

application example:

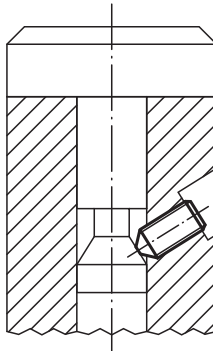

Material:

Steel or stainless steel (A 2)

Surface finish:

Steel class 45 H, black;
stainless steel A 2-70, natural finish

Sample order:

nIm 07166-110X12 (Please also indicate dimension L)

Note:

The screw lengths 14, 70 and 80 are not available in stainless steel.

Order No. steel	Order No. stainless steel	D	L	D1	T	SW
07166-03X	07166-103X	M3	5/6/8/10/12/16/20	-	1,2	1,5
07166-04X	07166-104X	M4	5/6/8/10/12/16/20/25	-	1,5	2
07166-05X	07166-105X	M5	5/6/8/10/12/14/16/20/25/30	-	2	2,5
07166-06X	07166-106X	M6	6/8/10/12/16/20/25/30/35/40/45/50/60	1,5	2	3
07166-08X	07166-108X	M8	8/10/12/14/16/20/25/30/35/40/45/50/60	2	3	4
07166-10X	07166-110X	M10	10/12/16/20/25/30/35/40/45/50/60/70/80	2,5	4	5

Hexagon head bolts with shank

DIN 931/DIN EN ISO 4014/DIN EN 24014



Material:

Steel or stainless steel (A 2)

Surface finish:

Steel class 8.8, black;
stainless steel A 2-70, natural finish

Sample order:

nIm 07170-110X50 (Please also indicate dimension L)

Note:

The versions 07170-105X25 and 07170-105X45 are not available in stainless steel.

On request:

Wrench sizes to DIN ISO 272.
application example:

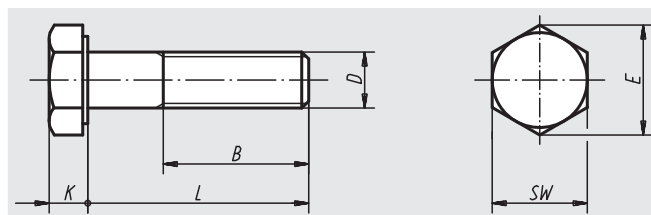
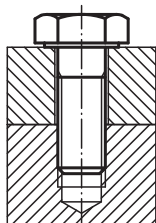

Order No. steel	Order No. stainless steel	D	L	B	SW	E	K
07170-04X	-	M4	25/30/35/40/45/50	14	7	7,66	2,8
07170-05X	07170-105X	M5	25/30/35/40/45/50/60	16	8	8,79	3,5
07170-06X	07170-106X	M6	30/35/40/45/50/60/70	18	10	11,05	4
07170-08X	07170-108X	M8	35/40/45/50/60/70/80	22	13	14,38	5,3
07170-10X	07170-110X	M10	40/45/50/60/70/80/90/100	26	17	18,9	6,4
07170-12X	07170-112X	M12	45/50/60/70/80/90/100/110/120	30	19	21,1	7,5
07170-16X	07170-116X	M16	60/70/80/90/100/110/120	38	24	26,75	10
07170-20X	-	M20	70/80/90/100/110/120	46	30	33,53	12,5