

Centring rings

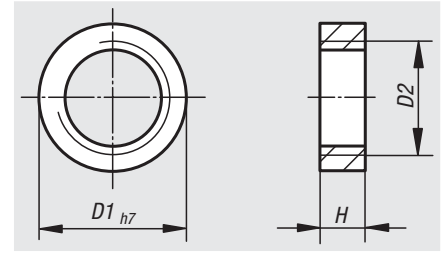

Material, surface finish:
Steel, black oxide finish

Sample order:
nlm 20240-0705

Note:
The centring rings which serve to connect modules precisely or the indirect mounting of modules are installed by means of adapter plates.
The internal thread serves to remove the centring rings.

Order No.	D1	D2	H	Approx. weight kg
20240-0705	7	M5	3	0,001
20240-1008	10	M8	4	0,002
20240-1310	13	M10	4	0,002

Notes

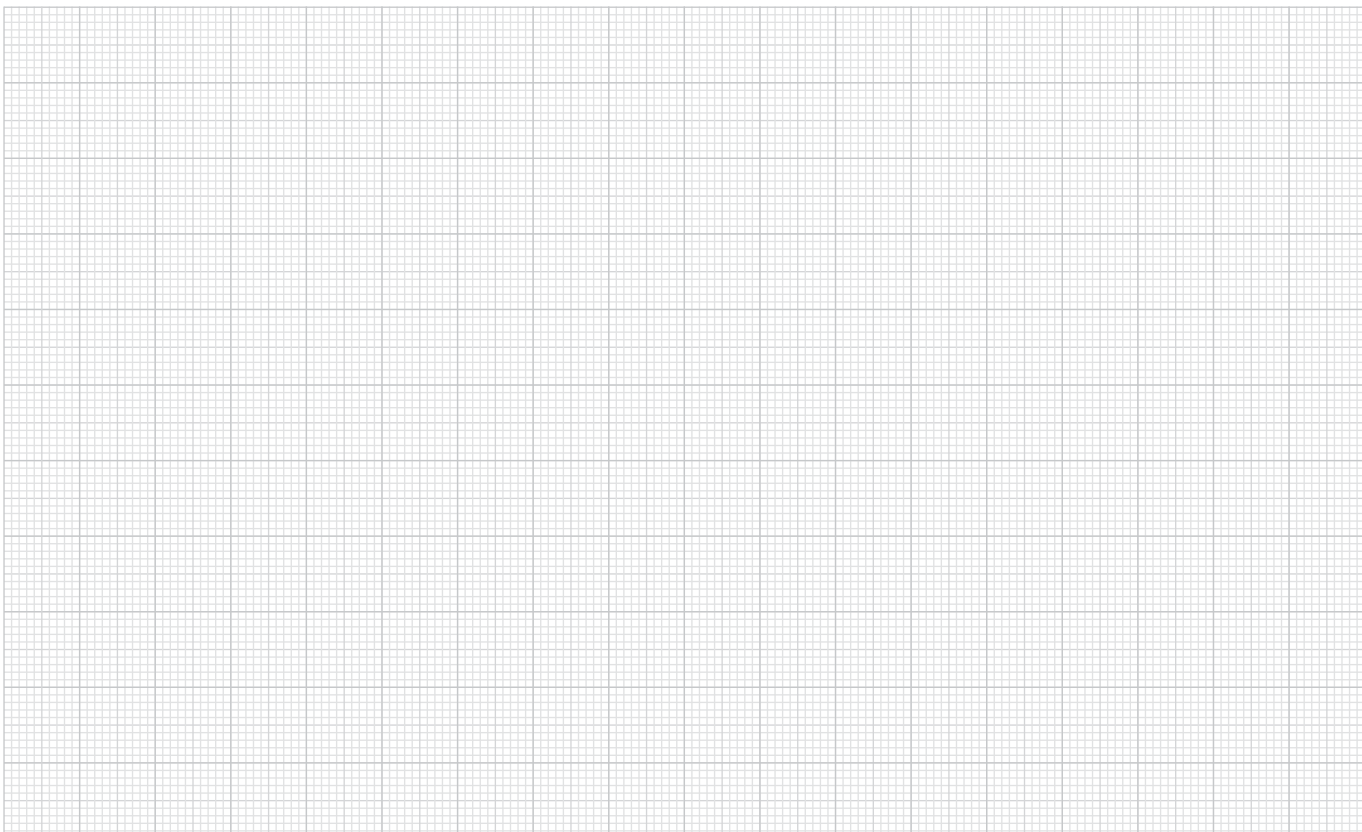

01000
02000
03000
04000
05000
06000
07000
08000
09000
20000
21000
22000
23000