

Linear ball bearings

with angle error adjustment



Material:
 Housing, plastic
 Track plates, roller bearing steel.
 Balls, steel.

Sample order:
 nlm 21510-1202

Note:
 The linear ball bearings correspond to series 3 of ISO 10285 with automatic angle error adjustment. With double-sided seal. These bearings comprise a highly precise die-cast plastic truss in which the clipped-on track plates of roller bearing steel are installed. The plastic truss serves at the same time as return and seal retainer. The seal consists of a special polyamide material with a low friction coefficient. The linear ball bearing is held in place by a retaining ring acc. to DIN 471/472.

Recommended tolerances:
 Shaft: h6
 Housing: H7

Linear ball bearings with double-sided seal should be lubricated before installation.

The specified basic load ratings apply upon insertion of hardened and ground shafts.

Temperature range:
 -20 °C up to +80 °C.

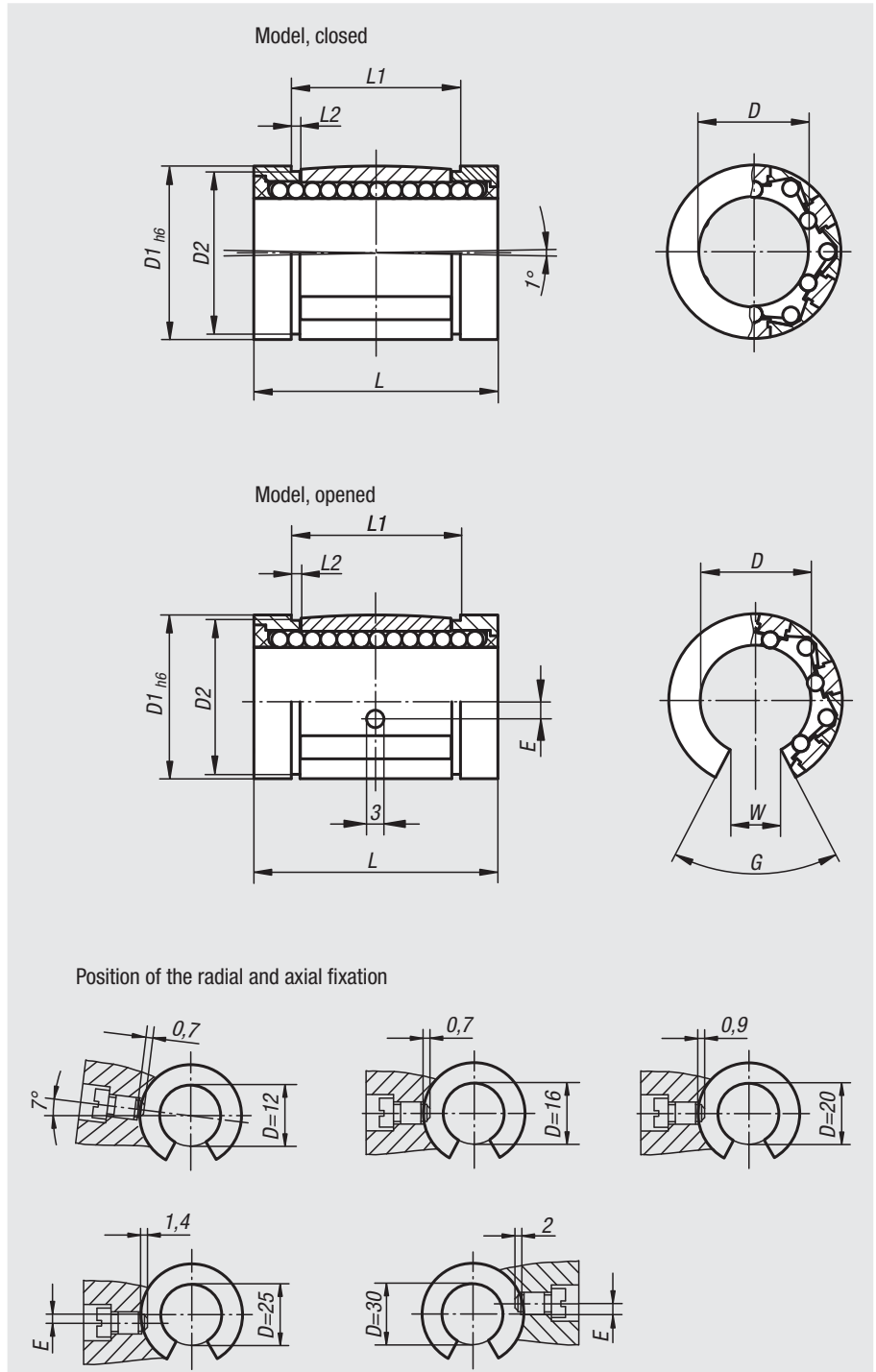

Order No. closed	Order No. open	D	D1	D2	E	G	L	L1	L2	W	Dynamic base loads N	Static base loads N	Approx. weight kg
21510-1202	21510-1212	12	22	21	-/1,35	-/66°	32 -0,2	22,9 -0,2	1,3	-/6,5	650	520	0,023
21510-1602	21510-1612	16	26	24,9	-/0	-/68°	36 -0,2	24,9 -0,2	1,3	-/9	800	630	0,028
21510-2002	21510-2012	20	32	30,3	-/0	-/55°	45 -0,2	31,5 -0,2	1,6	-/9	1500	1250	0,061
21510-2502	21510-2512	25	40	37,5	-/1,5	-/57°	58 -0,3	44,1 -0,3	1,85	-/11,5	2500	2200	0,122
21510-3002	21510-3012	30	47	44,5	-/2	-/57°	68 -0,3	52,1 -0,3	1,85	-/14	3200	2800	0,185

01000
02000
03000
04000
05000
06000
07000
08000
09000
20000
21000
22000
23000