

# Linear housing units

individual, open



**Material:**

Housing in aluminium

**Surface finish:**

Housing natural finish

**Sample order:**

nIm 21535-121012

**Note:**

The ready-to-install linear housing units consist of an extruded aluminium housing, installed linear ball bearings with angle error adjustment 21510 and double-sided seal. Mounting of the bearings within the housing with socket head screws.

Recommended shaft tolerance: h6.

Basic load ratings according to specification of the linear ball bearings.

**On request:**

Linear housing units can be equipped with all of the linear ball bearings presented in this catalogue.

**Accessory:**

Attachment seals 21560.

Precision guide shafts 21590 or 21595.

Fastening screws 07160 or 07161.

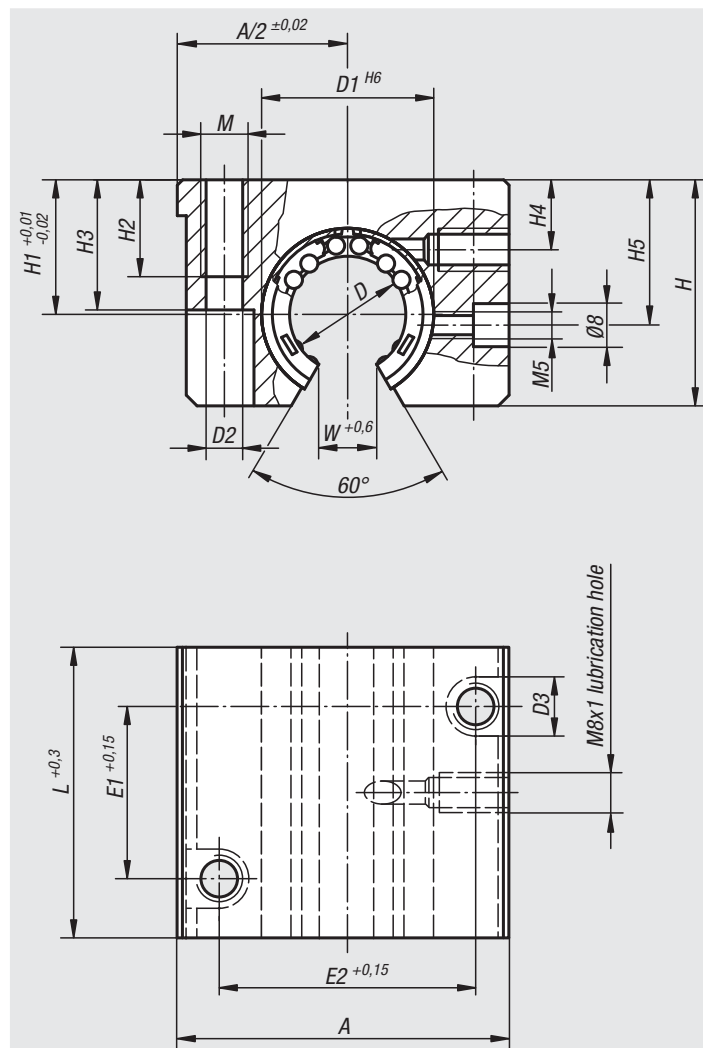

Order No.	A	D	D1	D2	D3	E1	E2	H	H1	H2	H3	H4	H5	L	M	W	Approx. weight kg
21535-121012	43	12	22	4,2	8	23	32	28	18	11	23,5	8	16,65	39	M5	7	0,110
21535-161012	53	16	26	5,2	10	26	40	35	22	13	30	12	22	43	M6	9,4	0,170
21535-201012	60	20	32	6,8	11	32	45	42	25	18	34	13	25	54	M8	10,2	0,300
21535-251012	78	25	40	8,6	15	40	60	51	30	22	40	15	31,5	67	M10	12,5	0,570
21535-301012	87	30	47	8,6	15	45	68	60	35	22	48	16	33	79	M10	13,9	0,860