

Linear housing units

tandem, open



Material:

Housing in aluminium

Surface finish:

Housing natural finish

Sample order:

n1m 21545-121012

Note:

The ready-to-install linear housing units consist of an extruded aluminium housing, four installed linear ball bearings with angle error adjustment 21510 and double-sided seal. Mounting of the bearings within the housing with socket head screws.

Recommended shaft tolerance: h6.

Basic load ratings according to specification of the linear ball bearings (x2).

On request:

Linear housing units can be equipped with all of the linear ball bearings presented in this catalogue.

Accessory:

Attachment seals 21560.
Precision guide shafts 21590 or 21595.
Fastening screws 07160 or 07161.

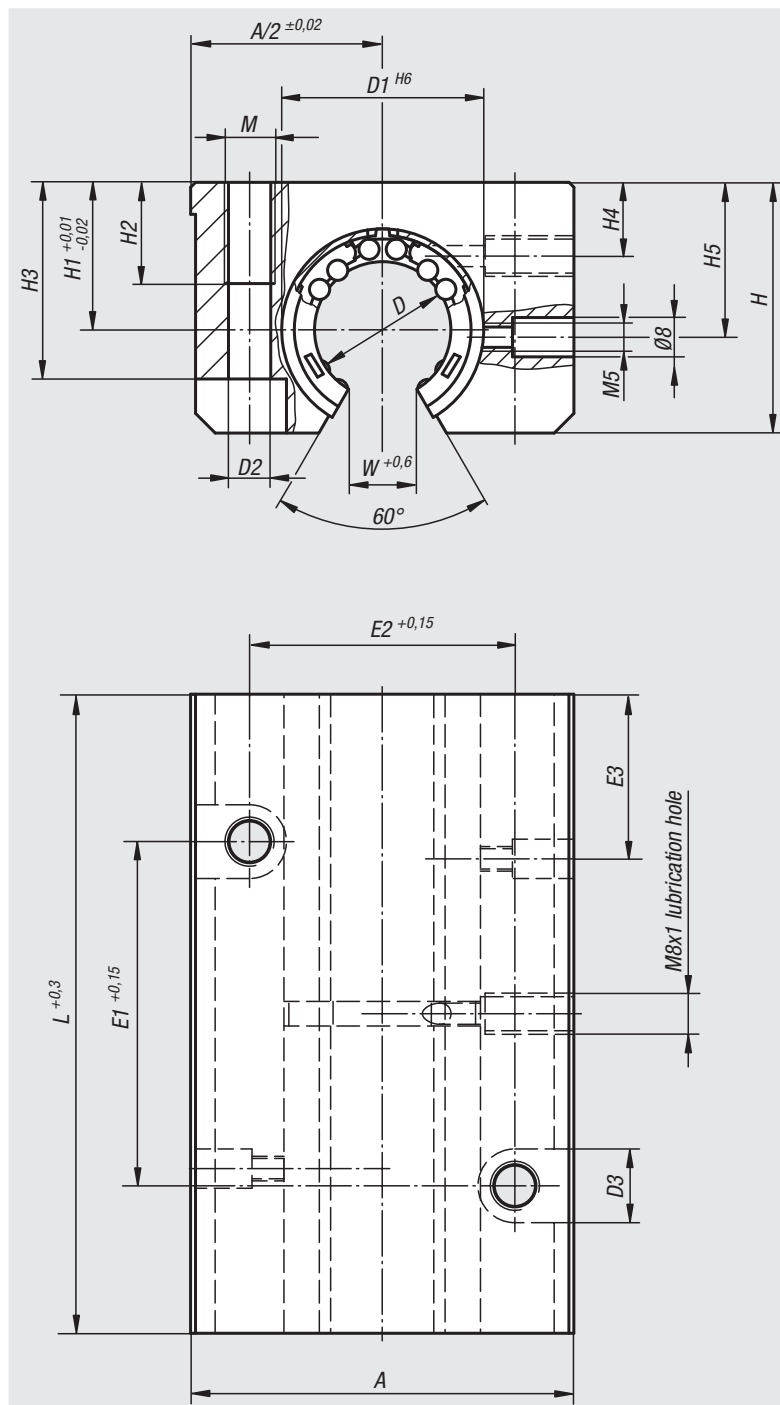

Order No.	A	D	D1	D2	D3	E1	E2	E3	H	H1	H2	H3	H4	H5	L	M	W	Approx. weight kg
21545-121012	43	12	22	5,2	10	40	30	19,5	30	18	13	25	8	16,65	76	M6	7	0,220
21545-161012	53	16	26	5,2	10	45	36	21,5	35	22	13	30	12	22	84	M6	9,4	0,340
21545-201012	60	20	32	6,8	11	55	45	27	42	25	18	34	13	25	104	M8	10,2	0,620
21545-251012	78	25	40	8,6	15	70	54	33,5	51	30	22	40	15	31,5	130	M10	12,9	1,170
21545-301012	87	30	47	10,3	18	85	62	39,5	60	35	26	48	16	33	152	M12	14,4	1,680