

# Straight and thrust bolts

to DIN 6321 (Edition 1973)



**Material:**  
Tool steel.

**Surface finish:**  
Hardened and ground.  
Support surface without centring.

**Sample order:**  
nlm 02020-212

**Note:**  
Thrust bolts form A serve as a mount for workpieces and fixtures.  
Straight bolts form B serve to position workpieces and fixture parts in holes with locating dimensions.  
The flattened form C can be used to bridge tolerances in hole spacing or to secure the part to be positioned in one direction only.  
Form A and B can also be used as hardened stop and as foot for fixtures.  
For similar bolts see 03120, 03130, 03140 and 03150.

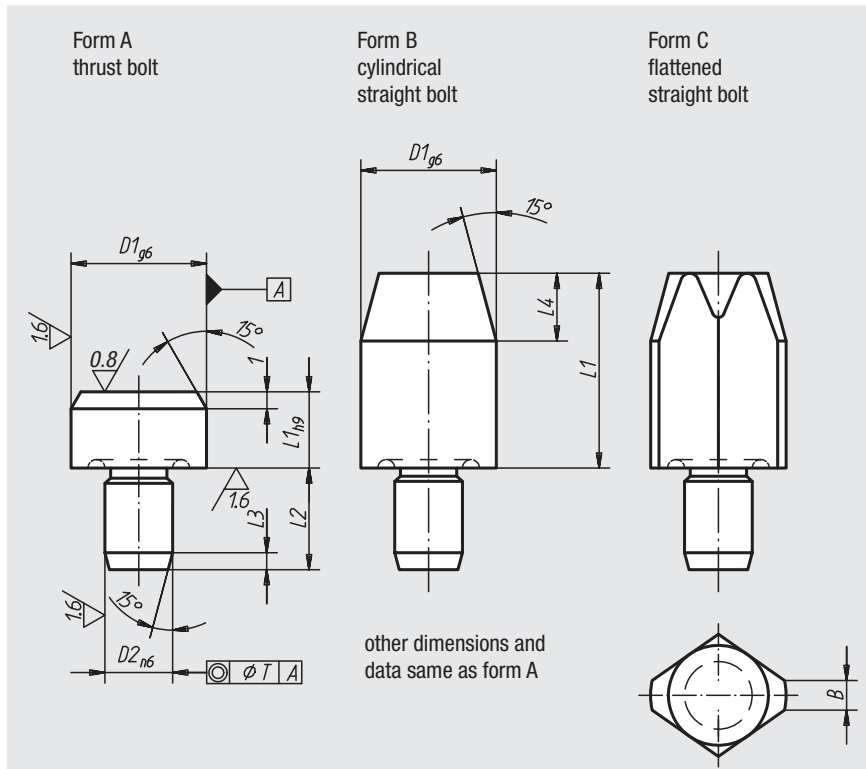

## Straight and thrust bolts

Order No.	Form	D1	L1	D2	L2	L3	T	Approx. weight g
02020-106	A	6	5	4	6	1,2	0,02	1,5
02020-110	A	10	6	6	9	1,6	0,02	5,5
02020-116	A	16	8	8	12	2	0,04	16,0
02020-125	A	25	10	12	18	2,5	0,04	50,0

## Straight bolts, short

Order No. Form B	Order No. Form C	Surface finish	D1	L1	D2	L2	L3	L4	B	T	Approx. weight g
02020-206	02020-406	short	6	7	4	6	1,2	4	-1	0,02	2
02020-208	02020-408	short	8	10	6	9	1,6	6	-1,6	0,02	6
02020-210	02020-410	short	10	10	6	9	1,6	6	-2,5	0,02	7
02020-212	02020-412	short	12	10	6	9	1,6	6	-2,5	0,02	8
02020-216	02020-416	short	16	13	8	12	2	8	-3,5	0,04	21
02020-220	02020-420	short	20	15	12	18	2,5	9	-5	0,04	46
02020-225	02020-425	short	25	15	12	18	2,5	9	-5	0,04	66

## Straight bolts, long

Order No. Form B	Order No. Form C	Surface finish	D1	L1	D2	L2	L3	L4	B	T	Approx. weight g
02020-306	02020-506	long	6	12	4	6	1,2	4	-1	0,02	3
02020-308	02020-508	long	8	16	6	9	1,6	6	-1,6	0,02	8
02020-310	02020-510	long	10	18	6	9	1,6	6	-2,5	0,02	10
02020-312	02020-512	long	12	18	6	9	1,6	6	-2,5	0,02	12
02020-316	02020-516	long	16	22	8	12	2	8	-3,5	0,04	31
02020-320	02020-520	long	20	25	12	18	2,5	9	-5	0,04	64
02020-325	02020-525	long	25	25	12	18	2,5	9	-5	0,04	98

