

Edge clamps



Material:
Steel

Surface finish:
Body heat-treated and black oxide finish, clamping disc case hardened and brass-coated

Sample order:
nlm 04439-14

Note:
The edge clamps can be used directly on machine tables or on adapter plates. The downward pressure keeps the workpiece immobile on the support. The clamping disc adapts to the angular position of the piece, i.e. the workpiece does not have to be orthogonal. The clamping disc has a smooth surface for machined pieces and a notched surface for rough pieces.

On request:
Spare eccentric screws.

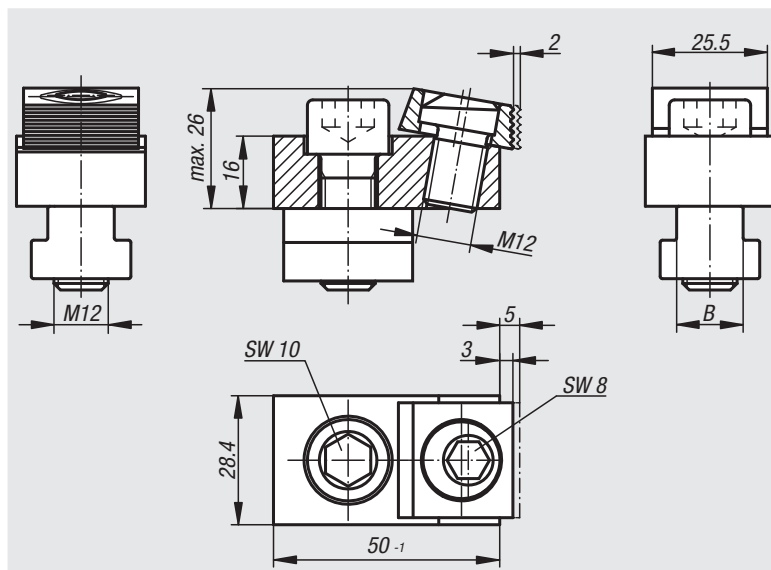

Order No.	B Slot width	Clamping force kN	Approx. weight kg
04439-00	without T-nut and fastening screw	18	0,180
04439-14	14	18	0,270
04439-16	16	18	0,279
04439-18	18	18	0,316