

# Taper clamps

clamping surface smooth or serrated



## Material, surface finish:

Double edge and clamping segments tempered steel, hardened and black

## Sample order:

nIm 04524-2208

## Note:

Their compact design makes the taper clamps especially suitable for multiple clamping. The hardened and ground taper surfaces make high clamping forces possible.

The appropriate taper clamps can be mounted either in a M.T.P. hole or a T-slot. Inserting a socket head screw moves the two clamping segments outwards and presses the workpieces against the fixed stop of the machining device.

Via the incorporated longhole the taper clamps can be displaced or balance tolerances.

Travel path according:

M8 = ±0.5 mm

M10 = ±1.0 mm

M12 = ±1.0 mm

M16 = ±1.5 mm

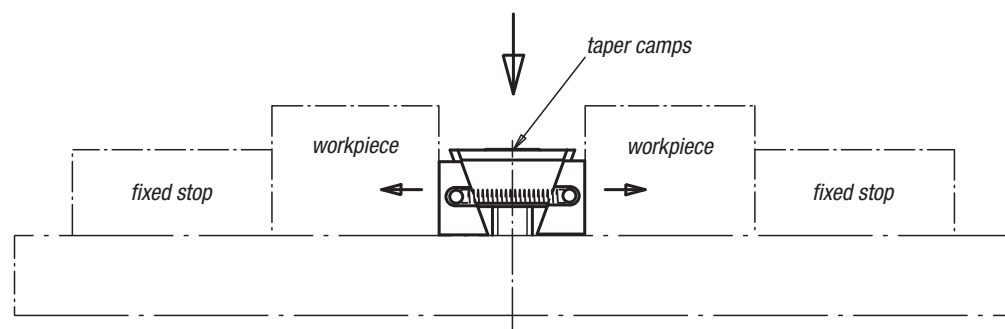
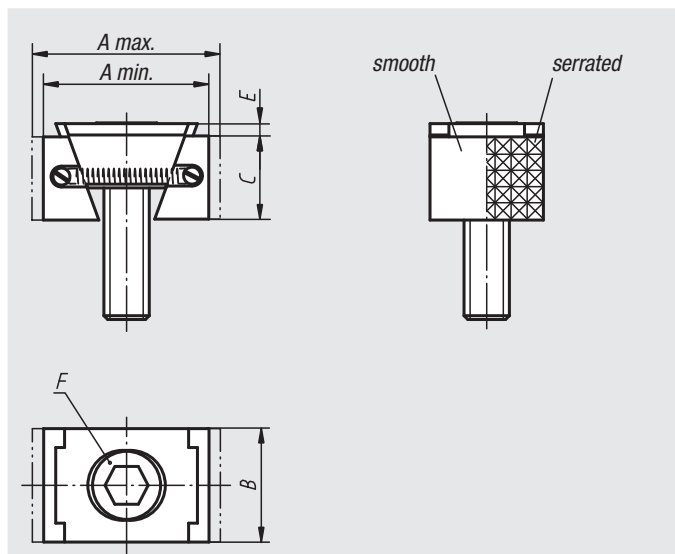

## Taper clamps, strait version

Order No. clamping surface smooth	Order No. clamping surface serrated	A min.	A max.	B	C	E	F Socket head screw DIN 6912	Clamping force kN	Tightening torque Nm
04524-1108	04524-2108	30,5	33,5	24	15	2	M8x25	15	25
04524-1110	04524-2110	32	37	28	19	3,5	M10x25	20	49
04524-1112	04524-2112	44	49,5	30	22	3,5	M12x40	30	85
04524-1116	04524-2116	55	62	40	29	4	M16x60	50	210

## Taper clamps, broad version

Order No. clamping surface smooth	Order No. clamping surface serrated	A min.	A max.	B	C	E	F Socket head screw DIN 6912	Clamping force kN	Tightening torque Nm
04524-1208	04524-2208	30,5	33,5	30	15	2	M8x25	15	25
04524-1210	04524-2210	32	37	38	19	3,5	M10x25	20	49
04524-1212	04524-2212	44	49,5	48	22	3,5	M12x40	30	85
04524-1216	04524-2216	55	62	48	29	4	M16x60	50	210