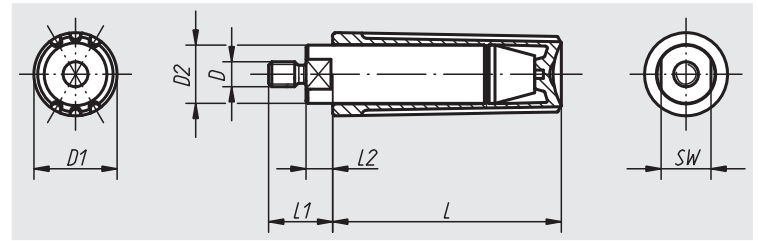

## Cylindrical revolving grips

**Material, surface finish:**

Anthracite grey thermoplastic.  
Steel parts black oxide finish.

**Sample order:**

nIm 06325-104

**Note:**

Cylindrical grips are supplied assembled and can be screwed to handwheels, spools and cranks.

Order No.	Size	D	D1	D2	L	L1	L2	SW	Approx. weight kg
06325-104	1	M4	13	9	35	11	5	8	0,013
06325-205	2	M5	16	11	44	13	5,5	10	0,025
06325-306	3	M6	20	14	55	14	5	12	0,050
06325-408	4	M8	25	18	70,5	25	13	15	0,103

## Notes

