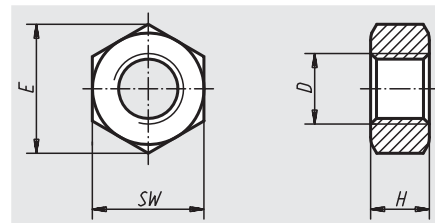

# Hexagon nuts

DIN 934/DIN EN ISO 4032/DIN EN 24032

**Material:**

Steel or stainless steel (A 2)

**Surface finish:**

Steel class 8, natural finish;  
stainless steel A 2-70, natural finish

**Sample order:**

nIm 07210-10

**Note:**

The quality class of a nut must always be the same or higher than the quality class of a bolt. That is, bolts in quality class 8.8 are always paired with a nut in quality class 8 (or higher, but never lower).

**On request:**

Wrench sizes to DIN ISO 272.

application example:

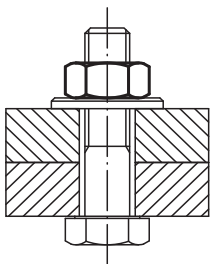

Order No. steel	Order No. stainless steel	D	E	H	SW
07210-03	07210-103	M3	6,01	2,4	5,5
07210-04	07210-104	M4	7,66	3,2	7
07210-05	07210-105	M5	8,79	4	8
07210-06	07210-106	M6	11,05	5	10
07210-08	07210-108	M8	14,38	6,5	13
07210-10	07210-110	M10	18,9	8	17
07210-12	07210-112	M12	21,1	10	19
07210-16	07210-116	M16	26,76	13	24
07210-20	07210-120	M20	32,95	16	30