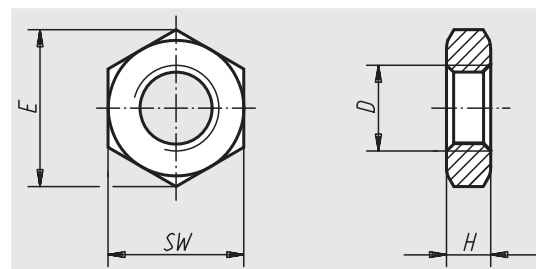

Hexagon thin nuts

DIN 439

**Material:**

Steel or stainless steel (A 2).

Surface finish:

Steel class 04, galvanized or black oxide finish.

Stainless steel (A 2), natural finish.

Sample order:

nlm 07212-10

Note:

This hexagon nut is used in bolted assemblies exposed to limited loads, e.g. as a conernut in forked joints or the head of an articulated joint.

Order No. galvanized steel	Order No. stainless steel	Order No. steel black oxide finish	Surface finish	D	E	H	SW
07212-05	07212-105	07212-205	right-hand thread	M5	8,79	2,7	8
07212-06	07212-106	07212-206	right-hand thread	M6	11,05	3,2	10
-	07212-1062	07212-2063	right-hand thread	M6x0,75	11,05	3,2	10
07212-08	07212-108	07212-208	right-hand thread	M8	14,38	4	13
-	07212-1083	07212-2083	right-hand thread	M8x1	14,38	4	13
07212-10	07212-110	07212-210	right-hand thread	M10	18,9	5	17
07212-103	07212-1103	07212-2103	right-hand thread	M10 x 1	18,9	5	17
07212-104	07212-1104	-	right-hand thread	M10 x 1,25	18,9	5	17
07212-12	07212-112	07212-212	right-hand thread	M12	21,1	6	19
07212-123	07212-1123	-	right-hand thread	M12 x 1,25	21,1	6	19
07212-124	07212-1124	07212-2124	right-hand thread	M12 x 1,5	21,1	6	19
07212-16	07212-116	07212-216	right-hand thread	M16	26,76	8	24
07212-163	07212-1163	07212-2163	right-hand thread	M16 x 1,5	26,76	8	24
07212-183	-	-	right-hand thread	M18 x 1,5	29,56	9	27
07212-203	07212-1203	07212-2203	right-hand thread	M20 x 1,5	32,95	10	30
07212-223	07212-1223	-	right-hand thread	M22 x 1,5	36,9	10	32
-	07212-1243	07212-2243	right-hand thread	M24x2	39,6	12	36
07212-061	07212-1061	-	left-hand thread	M6	11,05	3,2	10
07212-081	07212-1081	-	left-hand thread	M8	14,38	4	13
07212-101	07212-1101	-	left-hand thread	M10	18,9	5	17
07212-1031	07212-11031	-	left-hand thread	M10 x 1	18,9	5	17
07212-1041	07212-11041	-	left-hand thread	M10 x 1,25	18,9	5	17
07212-121	07212-1121	-	left-hand thread	M12	21,1	6	19
07212-1231	07212-11231	-	left-hand thread	M12 x 1,25	21,1	6	19
07212-1241	07212-11241	-	left-hand thread	M12 x 1,5	21,1	6	19
07212-161	07212-1161	-	left-hand thread	M16	26,76	8	24
07212-2031	07212-12031	-	left-hand thread	M20 x 1,5	32,95	10	30
07212-2231	07212-12231	-	left-hand thread	M22 x 1,5	36,9	10	32