

Quarter-turn screws



Material:
Tempered steel 1.1191

Surface finish:
Heat-treated class 8.8, black oxide finish

Sample order:
nlm 07570-10

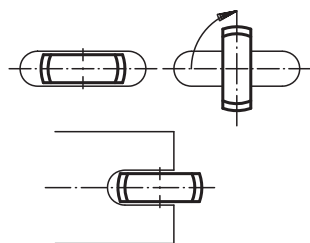
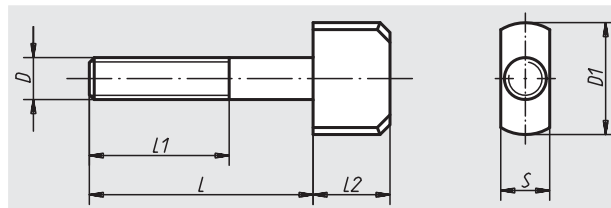

| Order No. | D | D1 | L | L1 | L2 | S | Approx. weight kg |
|-----------|-----|----|----|----|----|------|-------------------|
| 07570-06 | M6 | 20 | 30 | 25 | 14 | 6,5 | 0,018 |
| 07570-08 | M8 | 25 | 40 | 30 | 16 | 8,5 | 0,036 |
| 07570-10 | M10 | 28 | 50 | 40 | 16 | 10,5 | 0,051 |
| 07570-12 | M12 | 32 | 60 | 50 | 20 | 12,5 | 0,100 |

Notes

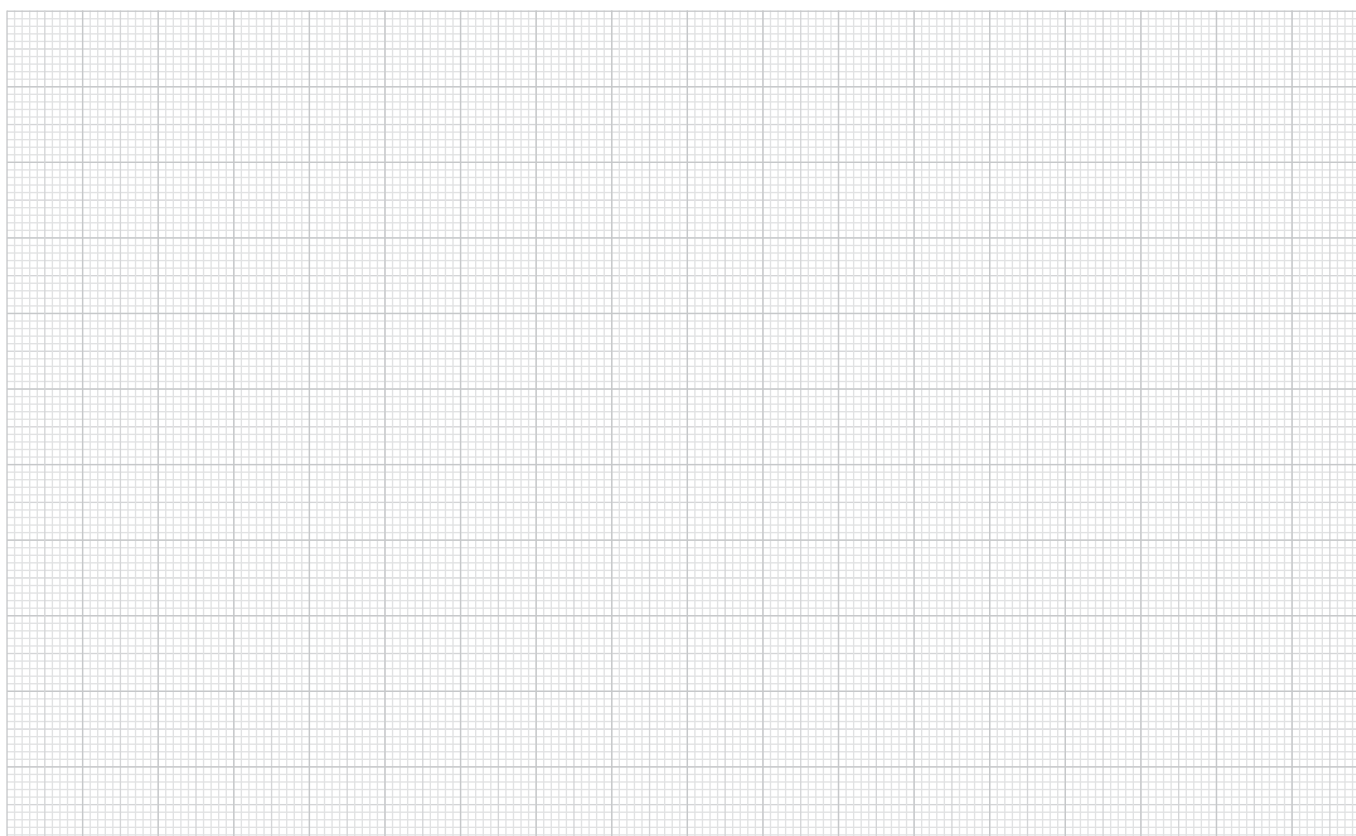

01000
02000
03000
04000
05000
06000
07000
08000
09000
20000
21000
22000
23000