

Cylindrical drill bushes to

DIN 179

**Material:**

Special hardened steel

Surface finish:

Hardened and ground.

Hardness 740 ±80 HV, quality class 10

Sample order:

nlm 08900-A0120X06

(cylindrical drill bush form A

with D1 = 1,2 mm and L = 6 mm)

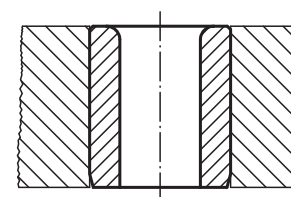
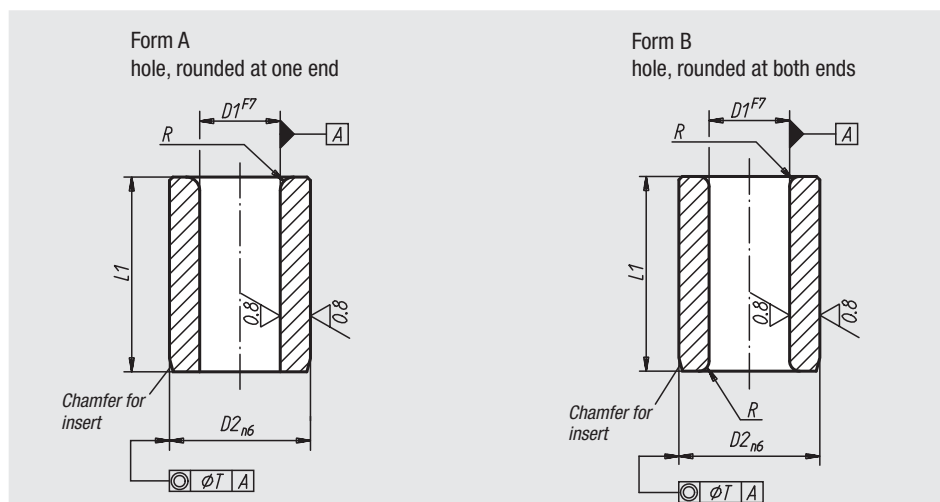

D1	D2	L1	Surface finish	R	T
from 0.4 up to 0.8	3	6	short	1	0,01
from 0.9 up to 1.0	3	6/9	short/medium	1	0,01
from 1.1 up to 1.8	4	6/9	short/medium	1	0,01
from 1.9 up to 2.6	5	6/9	short/medium	1	0,01
from 2.7 up to 3.3	6	8/12/16	short/medium/long	1	0,01
from 3.4 up to 4.0	7	8/12/16	short/medium/long	1	0,01
from 4.1 up to 5.0	8	8/12/16	short/medium/long	1	0,01
from 5.1 up to 6.0	10	10/16/20	short/medium/long	1,5	0,02
from 6.1 up to 8.0	12	10/16/20	short/medium/long	1,5	0,02
from 8.1 up to 10.0	15	12/20/25	short/medium/long	2	0,02
from 10.1 up to 12.0	18	12/20/25	short/medium/long	2	0,02
from 12.1 up to 15.0	22	16/28/36	short/medium/long	2	0,02
from 15.5 up to 18.0	26	16/28/36	short/medium/long	2	0,02
from 18.5 up to 22.0	30	20/36/45	short/medium/long	3	0,02
from 22.5 up to 26.0	35	20/36/45	short/medium/long	3	0,02
from 26.5 up to 30.0	42	25/45/56	short/medium/long	3	0,02
from 30.5 up to 35.0	48	25/45/56	short/medium/long	3	0,04
from 35.5 up to 42.0	55	30/56/67	short/medium/long	3,5	0,04
from 42.5 up to 48.0	62	30/56/67	short/medium/long	3,5	0,04