

Linear housing units

quadro, open



Material:

Housing in aluminium

Surface finish:

Housing natural finish

Sample order:

nlm 21555-121012

Note:

The ready-to-install linear housing units consist of an extruded aluminium housing, four installed linear ball bearings with angle error adjustment 21510 and double-sided seal. Mounting of the bearings within the housing with socket head screws.

Recommended shaft tolerance: h6.

Basic load ratings according to specification of the linear ball bearings (x4).

On request:

Linear housing units can be equipped with all of the linear ball bearings presented in this catalogue.

Accessory:

Attachment seals 21560.

Precision guide shafts 21590 or 21595.

Fastening screws 07160 or 07161.

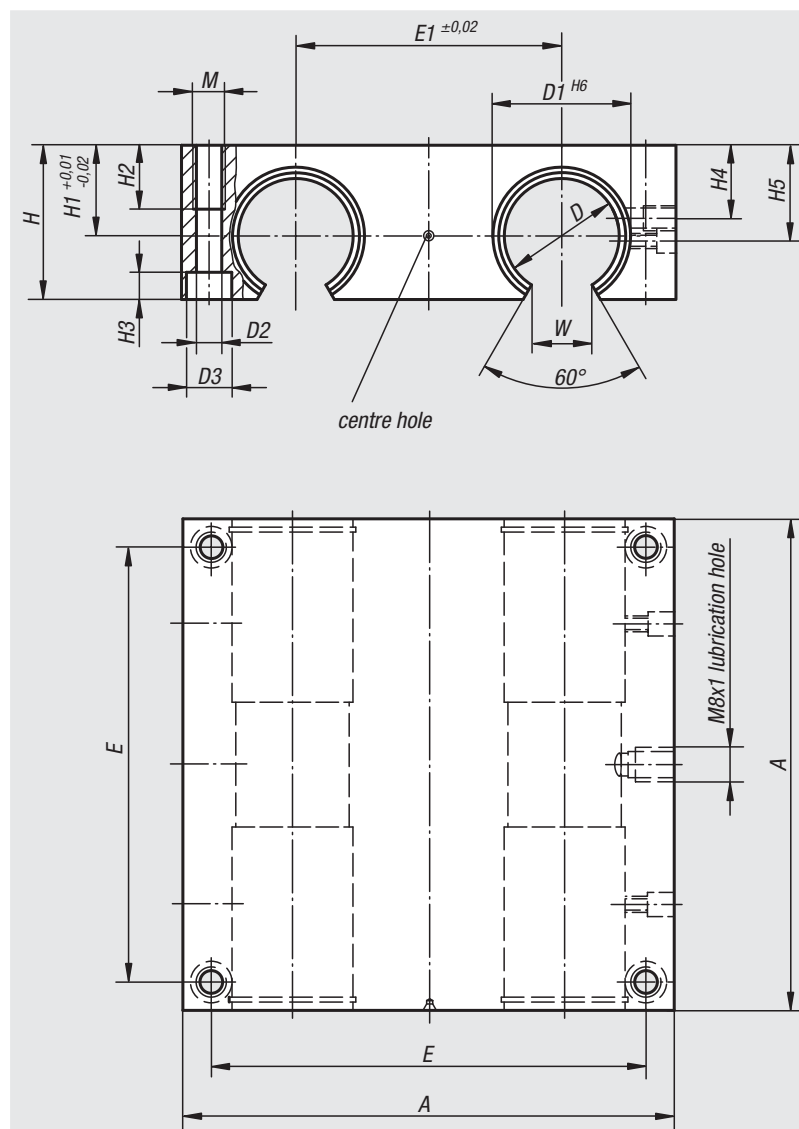

Order No.	A	D	D1	D2	D3	E	E1	H	H1	H2	H3	H4	H5	M	W	Approx. weight kg
21555-121012	85	12	22	5,3	10	73	42	30	18	13	5,4	10	16,65	M6	7	0,450
21555-161012	100	16	26	5,3	10	88	54	35	22	13	5,4	12	22	M6	9,4	0,730
21555-201012	130	20	32	6,8	11	115	72	42	25	18	6,4	13	25	M8	10,2	1,480
21555-251012	160	25	40	9	15	140	88	51	30	22	8,6	15	31,5	M10	12,9	2,680
21555-301012	180	30	47	10,5	18	158	96	60	35	26	10,6	16	33	M12	13,9	3,950