

# Threaded spindles for swivel feet

in steel or stainless steel

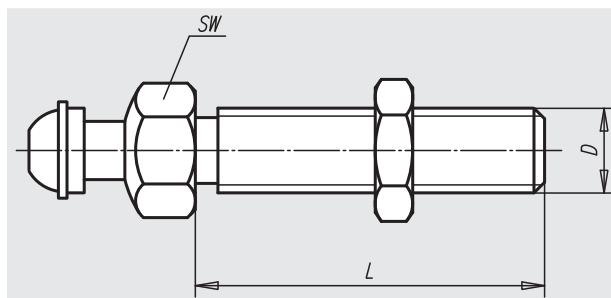

## Material:

Steel or stainless steel 1.4305.

## Surface finish:

Steel blue chromated.

Stainless steel, natural finish.

## Sample order:

nIm 27828-120661

27828-120661 and 27815-1060 **assembled**

## Note for ordering:

If the threaded spindle and the swivel foot plate are to be supplied assembled, please add the suffix „assembled“ to the order number for the spindle and plate. (e.g. 27828-120661 and 27815-1060 assembled.)

## Note:

Swivel feet consist of a plate and a threaded spindle.  
Any plate can be combined with any threaded spindle.  
The height of the complete swivel foot is calculated from the length of the threaded spindle + 30 mm.  
(Total height of swivel foot = L + 30 mm)

Order No. steel	Order No. stainless steel	D	L	SW	Load capacity max. kN	Approx. weight kg
27828-120661	27828-120662	M12	66	22	7,7	0,070
27828-121001	27828-121002	M12	100	22	7,7	0,094
27828-121251	27828-121252	M12	125	22	7,7	0,127
27828-121501	27828-121502	M12	150	22	7,7	0,130
27828-160661	27828-160662	M16	66	22	14,5	0,112
27828-161001	27828-161002	M16	100	22	14,5	0,152
27828-161251	27828-161252	M16	125	22	14,5	0,173
27828-161501	27828-161502	M16	150	22	14,5	0,235
27828-162001	27828-162002	M16	200	22	14,5	0,315
27828-201001	27828-201002	M20	100	22	24,3	0,237
27828-201251	27828-201252	M20	125	22	24,3	0,255
27828-201501	27828-201502	M20	150	22	24,3	0,341
27828-202001	27828-202002	M20	200	22	24,3	0,447